



Shelter for 1 car

\$4,000

PAGE 28

Basketball Ring

\$2,000

PAGE 57

Modwood Screen

\$1,000

PAGE 48



**HOMES
PLUS**

“Let’s start building...”



Homes Plus is a new way of delivering housing for Indigenous Communities in Australia. This program is about homes PLUS the additional items that make a house into your home.

YOU can select a Home and Add On package from this catalogue that suits your needs and your budget.

Houses are made in factories and taken to your land by a truck. And then you, your family and friends can build the extra items you chose to make it your home.

This catalogue will help you chose. Each Add On will come with instructions on how to construct it, how much time it will take, what tools are needed and the cost. The Homes Plus team can also help.

For more information visit

www.bowerhomesplus.com.au



Getting Started

This book is divided into 4 sections. The first will show you how to use the catalogue and keep track of your selections. It also contains information about the Homes Plus program.

Homes

Homes, catalogues the housing options available for this program. You can see the information about each house and make your selection based on your needs and budget.

Add Ons

Add Ons, outlines all the additional components you can order to personalise your new home and includes their price, purchaser commitment and assembly requirements. You can see more information about all the Add Ons on the website, **www.bowerhomesplus.com.au**

Contact Us

The last section has contact details for the Homes Plus Team. If you need help or more information on the program or making your selections use these contacts to get in touch.





"I can make my own choices."

Getting Started...

1. Choose your Home (Built by others)

You can browse the range of homes available to find the one that's right for your needs and budget. You can also view the details on the website www.bowerhomesplus.com.au. Use the drawings and information to choose the home that is best suited to you and those who will be living in it.

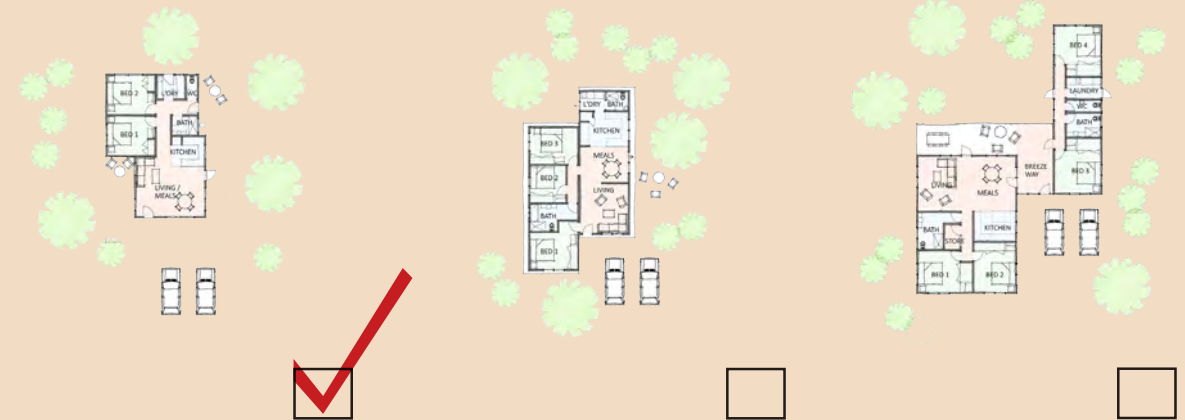

2. Choose your Add Ons (Built by YOU)

You get to decide what additional items will make your home function best for you. A carport perhaps? A vegie garden? A playground for the kids? YOU choose.

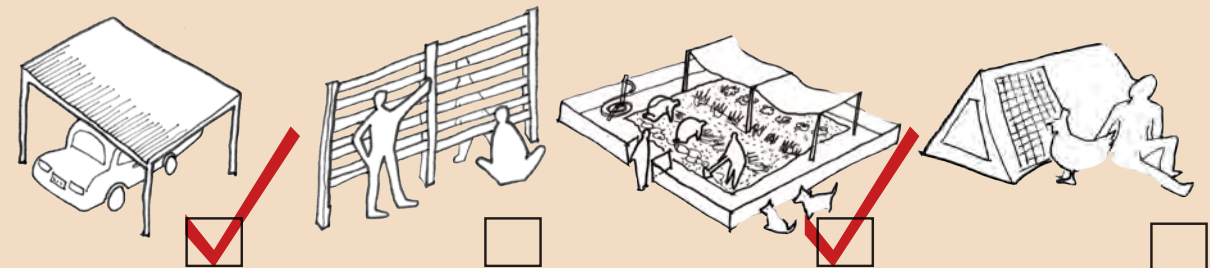

3. Site inspection

Not all sites are the same - some are flat, others are sloped. Some are in urban areas, others are outback. Some have trees and vegetation, others have a very solid soil. Once your selections have been submitted, the Homes Plus Team will take a look at your site, to confirm that the Home and Add Ons you've selected are suited for the site, the surrounds and local environment.



4. House is delivered and installed

Following the site inspection, your house will be delivered and installed on your site. You and the Homes Plus Team will confirm the location and it will be connected to services. You will be the resident of a new home, chosen by YOU!



5. Add Ons are delivered then built by YOU!

- > You decide where the Add On should be installed
- > You will learn new skills which you can use later to maintain the Add On
- > You will save money on labour and can buy more Add Ons

Arrives

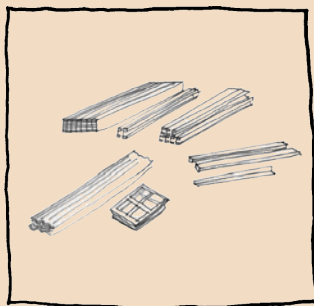

Materials are delivered

Build

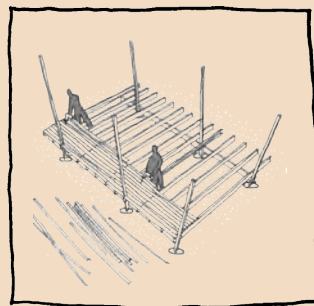

With the help of an instruction manual, some friends and the Homes Plus Team, you will build it

Complete

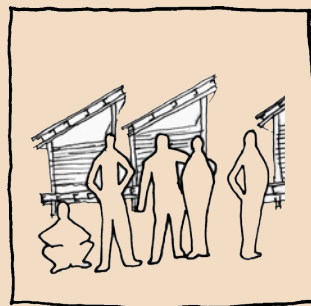

You will be the owner of a new Add On, with new skills learnt along the way

Symbols Explained...

People Power, Time and Difficulty Rating

As part of Home Plus, you will be required to get involved and help build the Add Ons you select for your Home. Each Add On item you see in the catalogue has a monetary cost but also an indication of how many people and how many days may be required to complete its construction and installation, as well as an indication of the complexity of the tasks.



2 people



4 people

Some jobs are small and you'll be able to complete them quickly with minimal assistance but most things get done faster with more hands to help. Each item in the catalogue shows how long it will take for 2 people or 4 people to complete the job.



Some jobs will get done in a day but others will require more time, if there a number of steps or if you need to wait for paint to dry or concrete to set you may need to allow a few days for the project to be finished. Each Add On has a time allocation listed to help you plan.

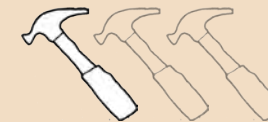

Easy

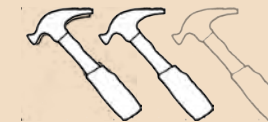

Medium

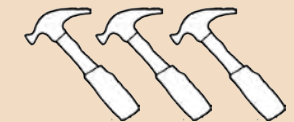

Harder

Some jobs will be easy and won't use too many tools or need special skills but others will need more assistance or have a tricky step or two. Each Add On has been rated to give you an idea of how complex a task it is.



"I'm ready to start building..."

Symbols Explained...

Safety, Tools and Equipment

Personal Protective Equipment (PPE) must be worn at all times when building. Each Add On in this catalogue lists what items of PPE are required for its construction. You will also need tool and other building equipment. These will be provided with the kit of parts when your Add On packages arrive. The Homes Plus team will have a lending library of certain tools, including ones that may require training and / or supervision.



Hard Hat



Boots



Ladder



Gloves



Power Drill



Spirit Level



Ear protection



Spade



Circular Saw



Eye Protection



Socket Set



Tape Measure



Fruit Tree
\$80

Placing Your Order...

There are two ways you can place your order for your new Home and Add On package.

Catalogue

You can keep track of your selected purchases, including the Home you have selected and the Add Ons you wish to order using the order forms at the back of this catalogue. Once you have confirmed your selections, including costs and labour requirements, ensure the form is complete with all your details and then tear it out and send it to the Homes Plus team.

If you do not have a Homes Plus ID, you should speak to your Aboriginal Corporation and discuss whether they are involved in the project. If they are part of the Homes Plus program and you are eligible, they will issue you with your unique Homes Plus ID.

As freight charges will vary depending on how many items you order and where you live, you will have to contact the Homes Plus team to establish the delivery charge. If you send your form in without a confirmed delivery cost, the Homes Plus team will contact you to confirm this.

Once Homes Plus receives your complete form, we will send you a receipt with a summary of your order, then you will be contacted to commence the site inspection and delivery process. Alternatively, you can complete your order online at www.bowerhomesplus.com.au.

Online

You may wish to complete your order online on our website www.bowerhomesplus.com.au.

The website is similar to this catalogue, including all the Homes and Add On options and their prices. You can add your Home and Add On selections to 'My Home' without logging in, however you will need to log in to confirm freight charges and to place your order.

Once Homes Plus receives your completed order, we will send you an email receipt with a summary of your order, then you will be contacted to commence the site inspection and delivery process.

Need Help?

If you require assistance with selecting and ordering, contact the Homes Plus Team online at www.bowerhomesplus.com.au.



Homes



“We get to make
choices that suit the
way we live”

Choose your Home...

There are a number of homes you can choose from. Use the catalogue to select which home is right for your needs and budget. Your home will be built in a factory and delivered to your site by truck ready for you to build your selected Add Ons.

Home A

2 BED 1 BATH

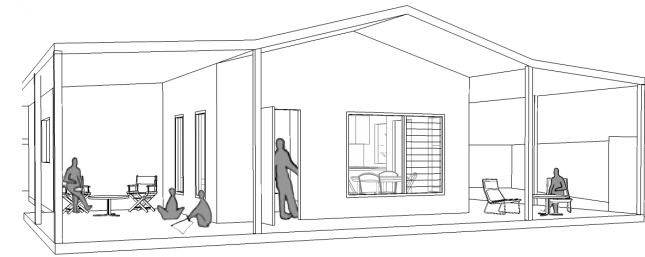

This home will suit smaller family groups. The open plan design allows flexible use of the living and dining areas.

Home B

3 BED 2 BATH

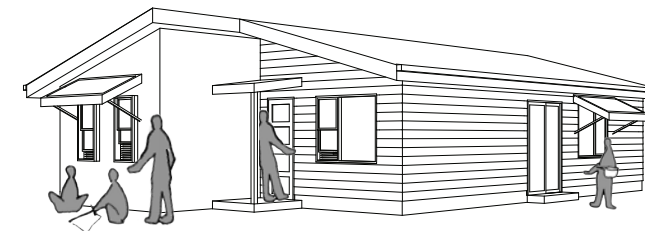

This home will suit family groups who want more space. 3 bedrooms, 2 bathrooms and separate eating and living zones provide many options for accommodating temporary visitors.

Home C

4/5 BED 2 BATH



This home can accommodate larger family groups with two distinct sleeping zones that share a large living and eating space.



*furniture not included

HOME A

\$395,000

2 BED 1 BATH

This home will suit smaller family groups. The open plan design allows flexible use of the living and meals areas as potential additional sleeping zones.

- The selection of durable fixtures and finishes is undertaken in consultation with residents.
- The home complies with the National Indigenous Housing Guide with a focus on personal and family wellbeing though attention to health and safety.
- Engineer designed reinforced concrete slab for durability and thermal efficiency.
- Lockable storage in each bedroom.
- Choice of wall cladding material– Colorbond Custom Orb or JH Scyon in a large selection of colours.
- Lightweight construction on a concrete slab with a high level of insulation in ceilings and walls to help moderate internal temperatures.
- Windows placed to encourage cross-flow-ventilation.
- Plenty of storage, including lockable cupboard, in kitchen.
- Choice of internal colour schemes.
- Passive design principles, environmentally responsible and energy efficient.
- Solid external and internal doors.
- Anti-mould paint in all wet areas.
- Powdercoated aluminium doors and windows with security screens.

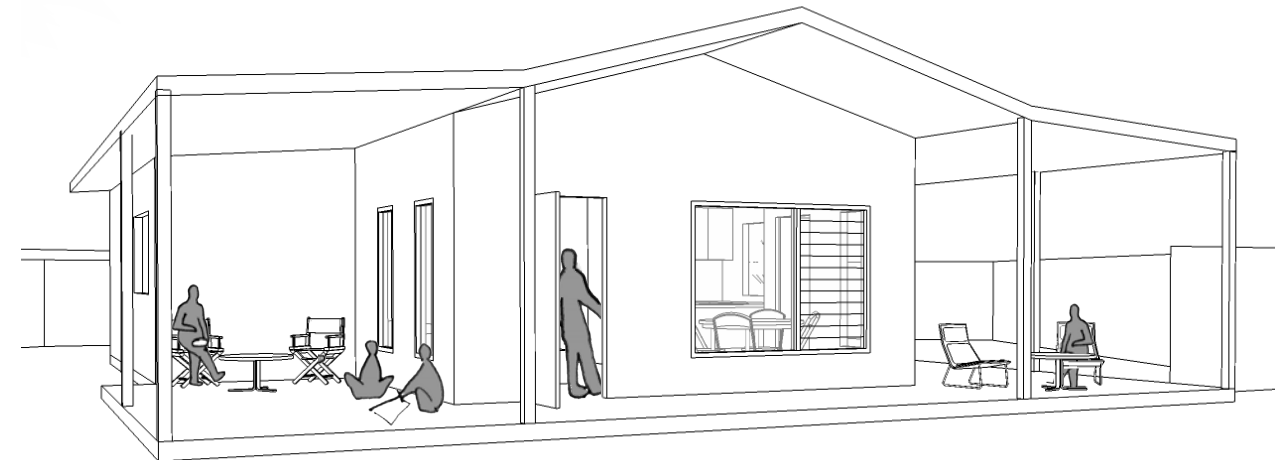



HOME B

\$465,000

3 BED 2 BATH

This home will suit family groups who want more space. 3 bedrooms, 2 bathrooms and separate eating and living zones provide many options for accommodating temporary visitors.

- The selection of durable fixtures and finishes is undertaken in consultation with residents.
- The home complies with the National Indigenous Housing Guide with a focus on personal and family wellbeing though attention to health and safety.
- Engineer designed reinforced concrete slab for durability and thermal efficiency.
- Lockable storage in each bedroom.
- Choice of wall cladding material– Colorbond Custom Orb or JH Scyon in a large selection of colours.
- Lightweight construction on a concrete slab with a high level of insulation in ceilings and walls to help moderate internal temperatures.
- Windows placed to encourage cross-flow-ventilation.
- Plenty of storage, including lockable cupboard, in kitchen.
- Choice of internal colour schemes.
- Passive design principles, environmentally responsible and energy efficient.
- Solid external and internal doors.
- Anti-mould paint in all wet areas.
- Powdercoated aluminium doors and windows with security screens.

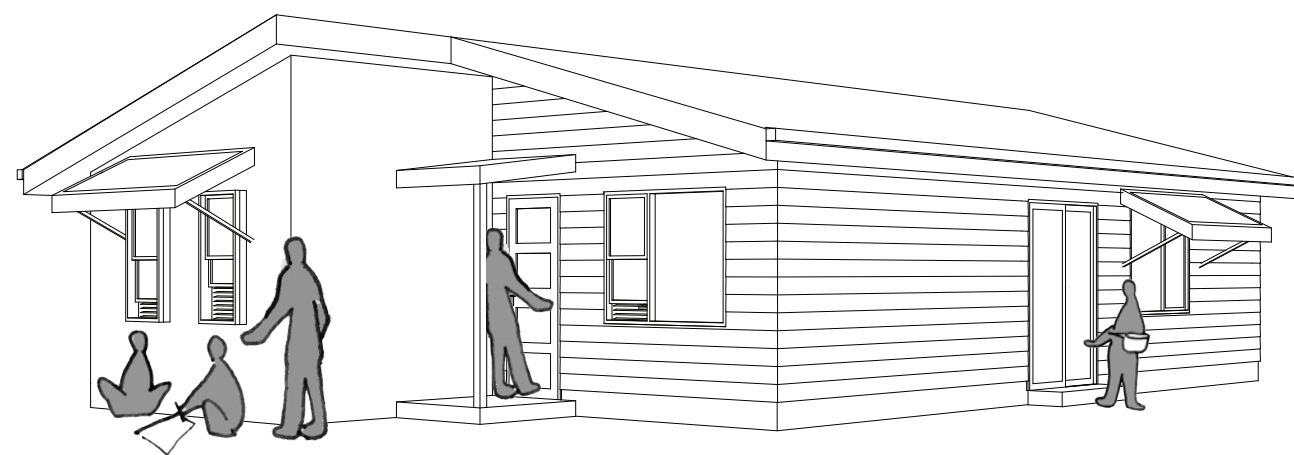



HOME C

\$545,000

4/5 BED 2 BATH

This home can accommodate larger family groups with two distinct sleeping zones that share a large living and eating space.

- The selection of durable fixtures and finishes is undertaken in consultation with residents.
- The home complies with the National Indigenous Housing Guide with a focus on personal and family wellbeing though attention to health and safety.
- Engineer designed reinforced concrete slab for durability and thermal efficiency.
- Lockable storage in each bedroom.
- Choice of wall cladding material– Colorbond Custom Orb or JH Scyon in a large selection of colours.
- Lightweight construction on a concrete slab with a high level of insulation in ceilings and walls to help moderate internal temperatures.
- Windows placed to encourage cross-flow-ventilation.
- Plenty of storage, including lockable cupboard, in kitchen.
- Choice of internal colour schemes.
- Passive design principles, environmentally responsible and energy efficient.
- Solid external and internal doors.
- Anti-mould paint in all wet areas.
- Powdercoated aluminium doors and windows with security screens.

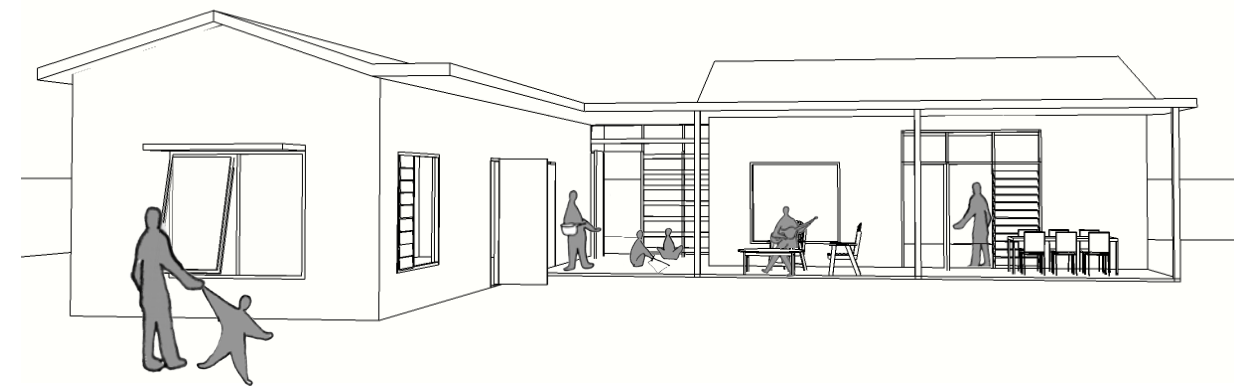



Add Ons

Kitchen Shelter + Slab

\$8,000

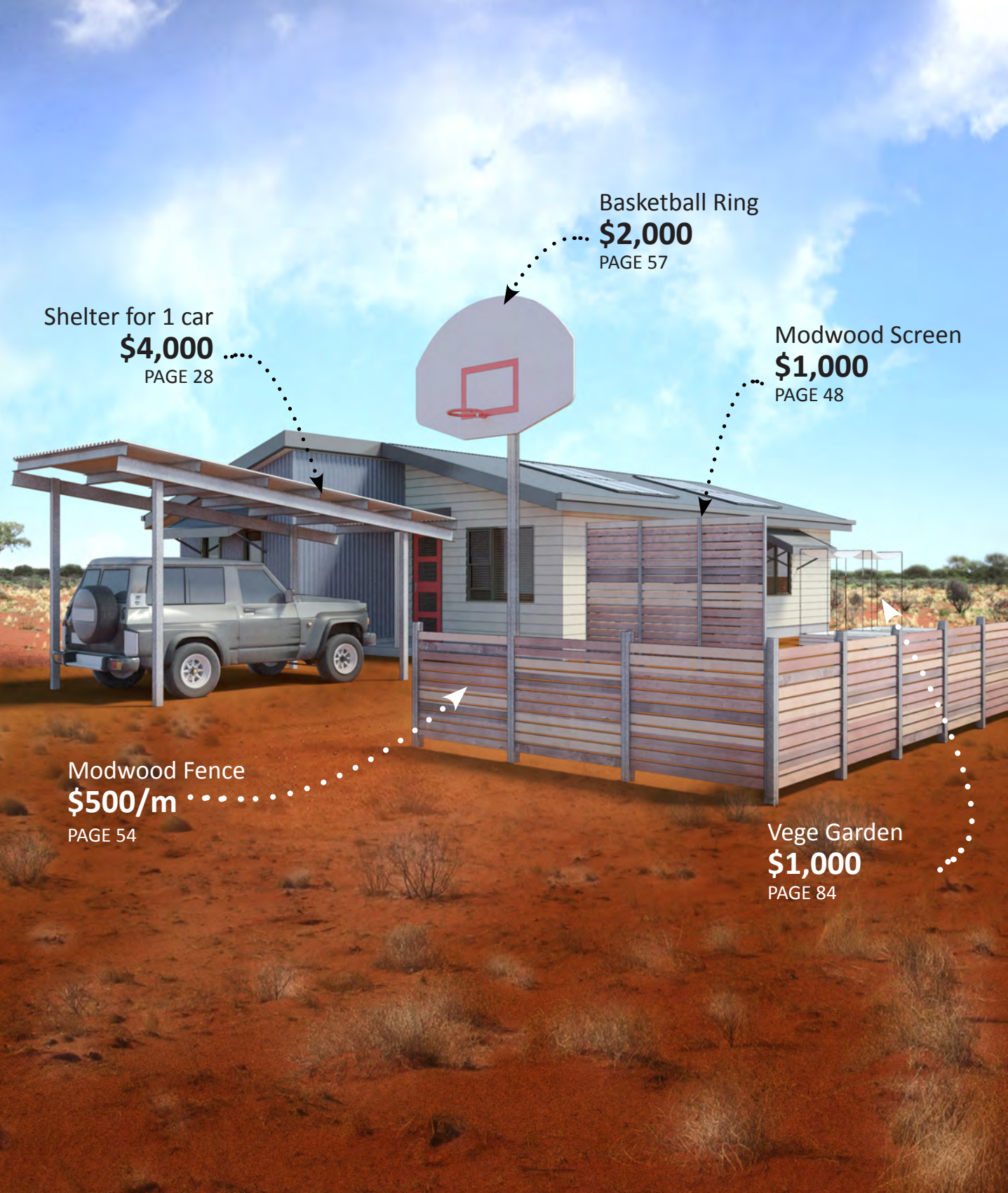

Shelter for 1 car
\$4,000
PAGE 28

Basketball Ring
\$2,000
PAGE 57

Modwood Screen
\$1,000
PAGE 48

Modwood Fence
\$500/m
PAGE 54

Vege Garden
\$1,000
PAGE 84



SHELTERS

page 26



FENCING & SCREENING

page 44



STORAGE

COMING SOON



PLAY

COMING SOON



WASHING

COMING SOON



GARDEN

COMING SOON

....a shelter for cars

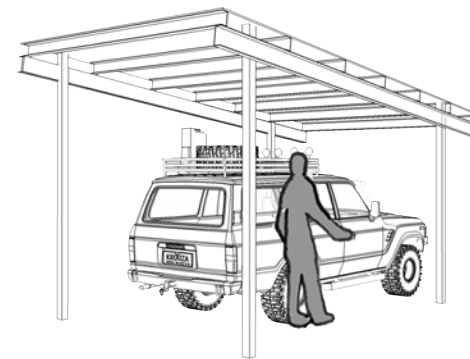

Shelter for 1 car **\$4,000**

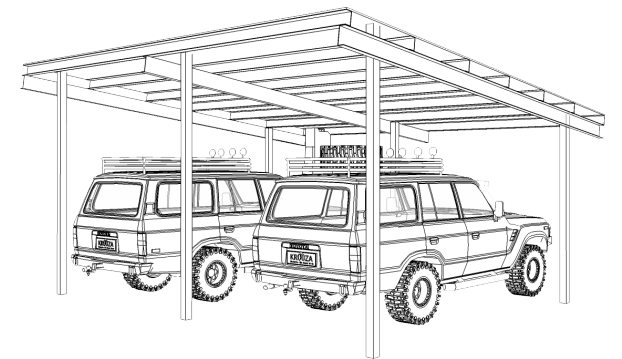

Shelter for 2 cars **\$7,000**

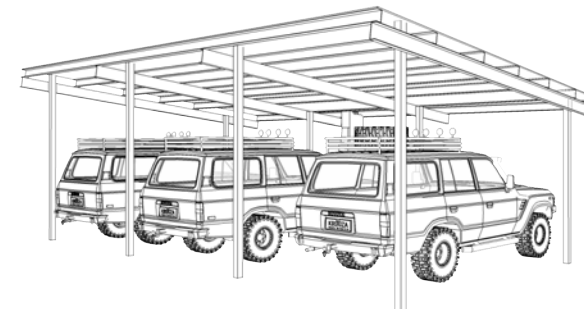

Shelter for 3 cars **\$10,000**

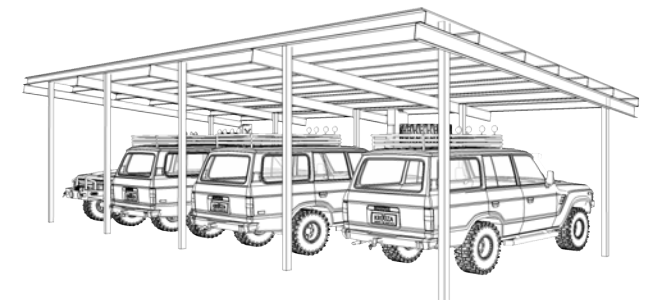

Shelter for 4 cars **\$12,000**

Add-Ons

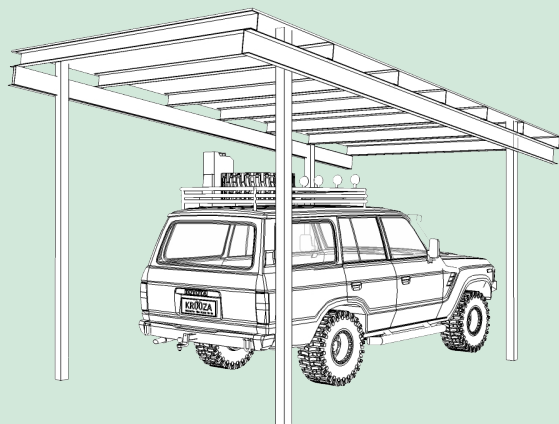

\$4,000

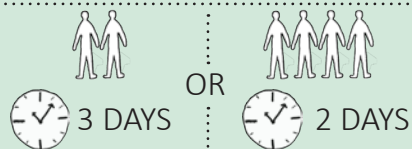

SHELTER FOR 1 CAR

DIMENSIONS

Width 3.3 metres
Height 2.7 metres
Length 5.7 metres.

DESCRIPTION

Steel framed carport with Zincalume roofing. Available as a freestanding carport or attached to the home. Concrete footings ensures stability.

CONTENTS

4 x Steel posts
10 x Steel purlins
5 x sheets Zincalume Roofing
55 x Bolts and washers
35 x Tek screws
Concrete mix as required

TOOLS AND EQUIPMENT



CONSTRUCTION OVERVIEW



Digging holes



Bolting steel together

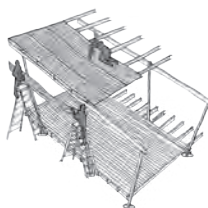

Screwing on roofing

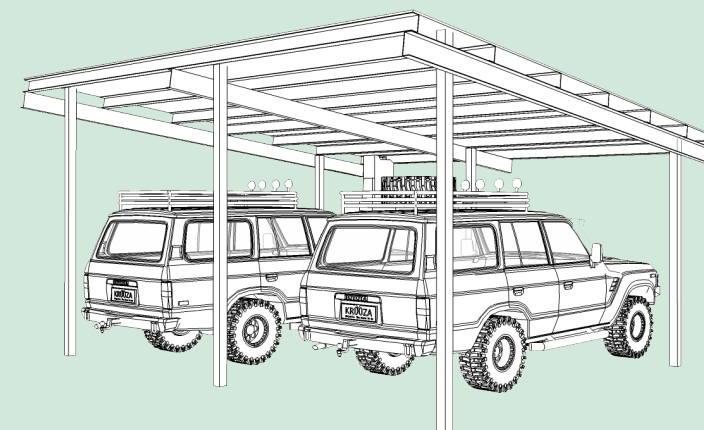

\$7,000

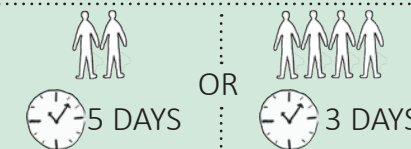

SHELTER FOR 2 CARS

DIMENSIONS

Width 6.4 metres
Height 2.7 metres
Length 5.7 metres.

DESCRIPTION

Steel framed carport with Zincalume roofing. Available as a freestanding carport or attached to the home. Concrete footings ensures stability.

CONTENTS

6 x Steel posts
10 x Steel purlins
8 x sheets Zincalume Roofing
80 x Bolts and washers
70 x Tek screws
Concrete mix as required

TOOLS AND EQUIPMENT



CONSTRUCTION OVERVIEW



Digging holes



Bolting steel together

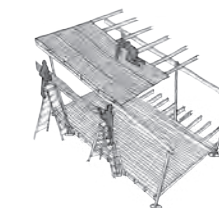

Screwing on roofing

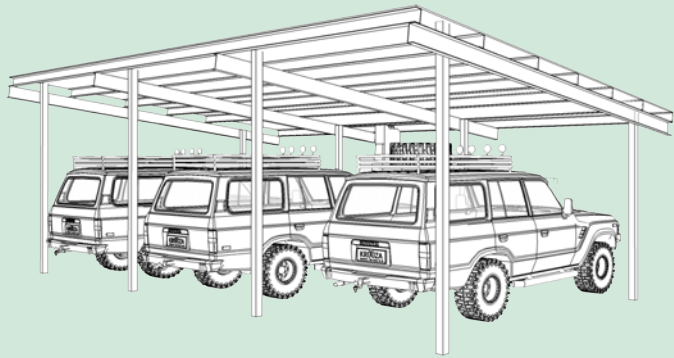

\$10,000

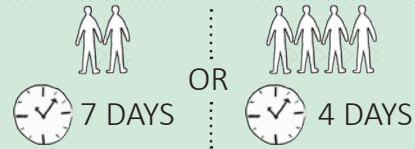

SHELTER FOR 3 CARS

DIMENSIONS

Width 9.5 metres
Height 2.7 metres
Length 5.7 metres.

DESCRIPTION

Steel framed carport with Zincalume roofing. Available as a freestanding carport or attached to the home. Concrete footings ensures stability.

CONTENTS

8 x Steel posts
20 x Steel purlins
12 x sheets Zincalume Roofing
130 x Bolts and washers
105 x Tek screws
Concrete mix as required

TOOLS AND EQUIPMENT



CONSTRUCTION OVERVIEW



Digging holes



Bolting steel together

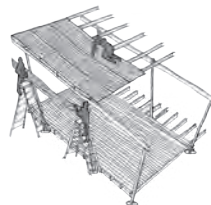

Screwing on roofing

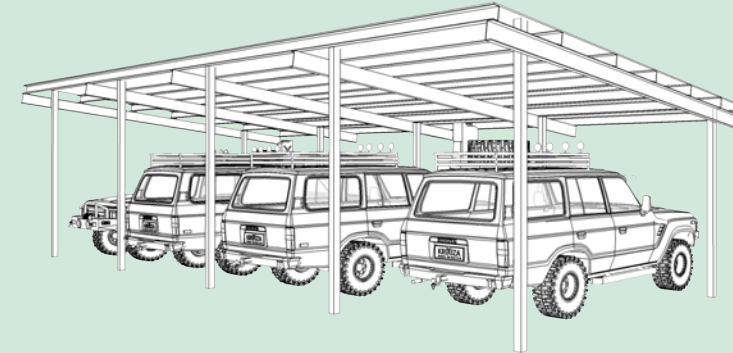

\$12,000

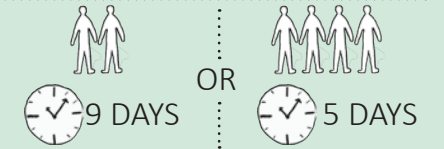

SHELTER FOR 4 CARS

DIMENSIONS

Width 12.6 metres
Height 2.7 metres
Length 5.7 metres.

DESCRIPTION

Steel framed carport with Zincalume roofing. Available as a freestanding carport or attached to the home. Concrete footings ensures stability.

CONTENTS

10 x Steel posts
20 x Steel purlins
16 x sheets Zincalume Roofing
55 x Bolts and washers
160 x Tek screws
Concrete mix as required

TOOLS AND EQUIPMENT



CONSTRUCTION OVERVIEW



Digging holes



Bolting steel together

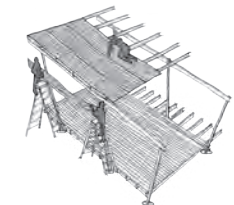

Screwing on roofing



“Breezy and shady...”

....a shelter for living

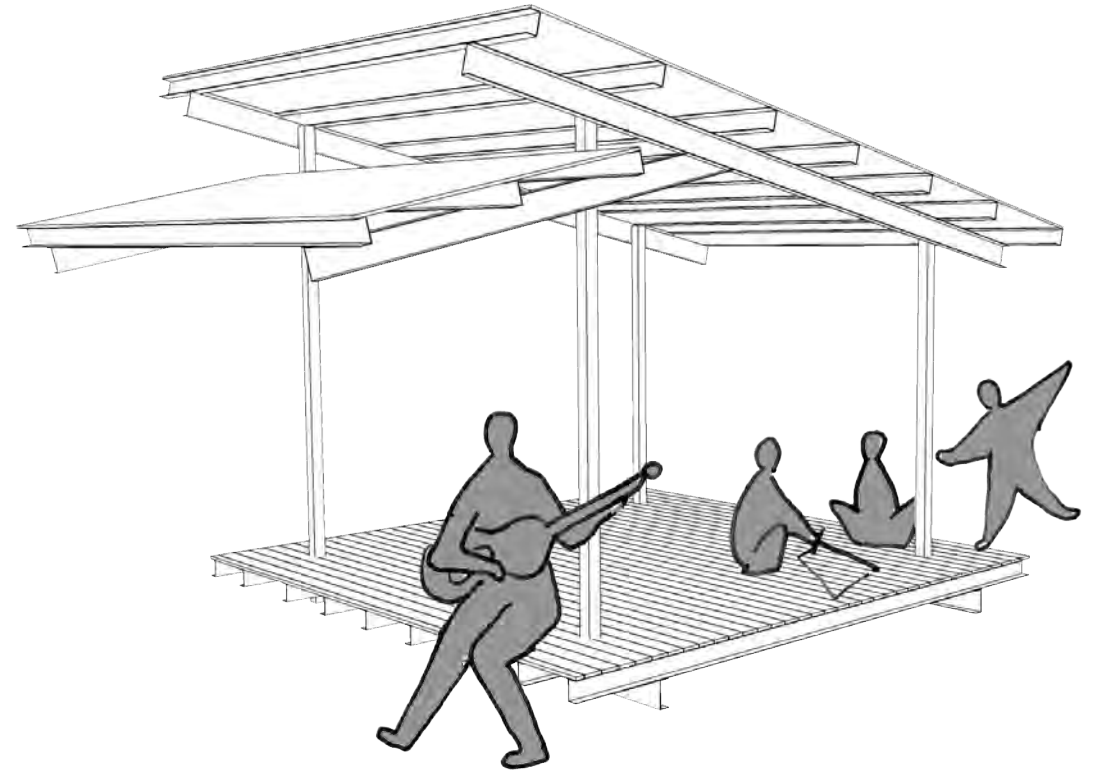

Outdoor Living Shelter + The Works **\$7,000**

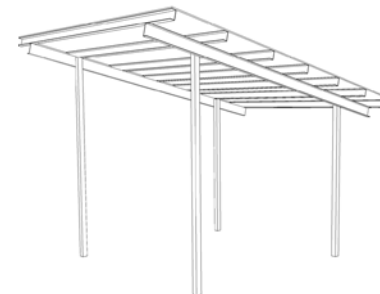

Basic **\$4,000**

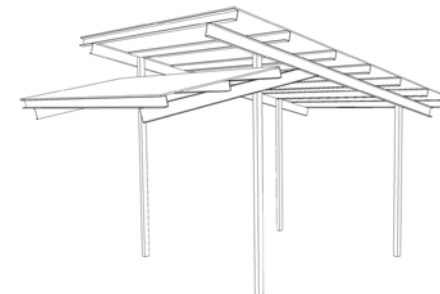

Basic + Roof **\$5,000**

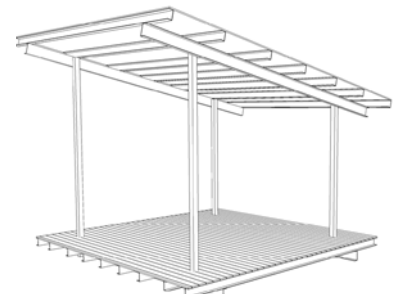

Basic + Deck **\$6,000**

Add-Ons

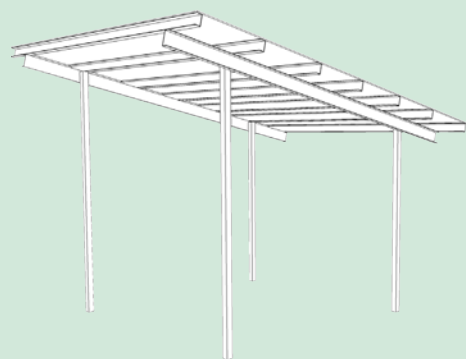

\$4,000

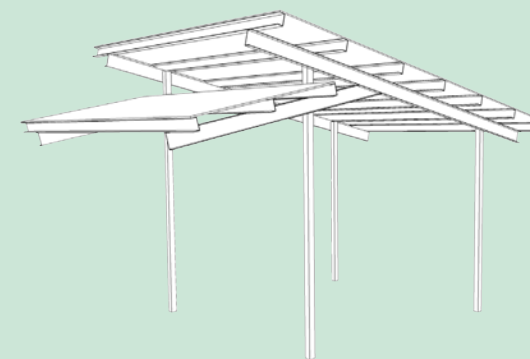
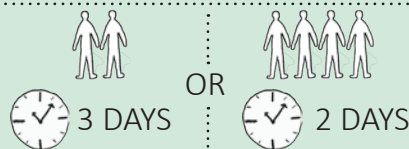

\$5,000

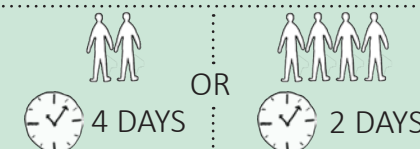

BASIC LIVING SHELTER

DIMENSIONS

Width 4.0 metres
Height 2.7 metres
Length 4.0 metres.

DESCRIPTION

Steel framed outdoor living shelter with Zincalume roof. Simple structure which can be used for many different purposes.

CONTENTS

4 x Steel posts
10 x Steel purlins
5 x sheets Zincalume Roofing
55 x Bolts and washers
35 x Tek screws
Concrete mix as required

TOOLS AND EQUIPMENT



CONSTRUCTION OVERVIEW



Digging holes



Bolting steel together



Screwing on roofing

BASIC LIVING SHELTER + ROOF

DIMENSIONS

Width 4.0 metres
Height 2.7 metres
Length 5.0 metres.

DESCRIPTION

Steel framed living shelter with Zincalume roof. Secondary roof provides additional shelter.

CONTENTS

4 x Steel posts
10 x Steel purlins
7 x sheets Zincalume Roofing
65 x Bolts and washers
55 x Tek screws
Concrete mix as required

TOOLS AND EQUIPMENT



CONSTRUCTION OVERVIEW



Digging holes



Bolting steel together

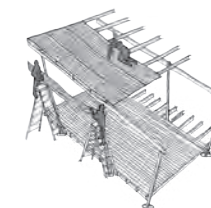

Screwing on roofing

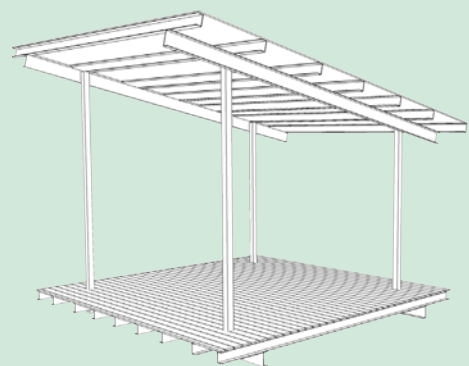

\$6,000

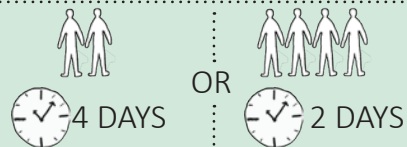

BASIC LIVING SHELTER + DECK

DIMENSIONS

Width 4.0 metres
Height 2.7 metres
Length 4.0 metres.

DESCRIPTION

Steel framed living shelter with Zinalume roof and raised platform with Modwood decking. Low maintenance and easy to clean.
Platform 0.5 high.

CONTENTS

4 x Steel posts
20 x Steel purlins
5 x sheets Zinalume Roofing
23 x Modwood Decking boards
110 x Bolts and washers
600 x Tek screws
Concrete mix as required

TOOLS AND EQUIPMENT



CONSTRUCTION OVERVIEW



Digging holes



Bolting steel together

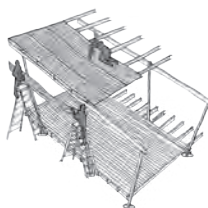

Screwing on roofing



Install Platform

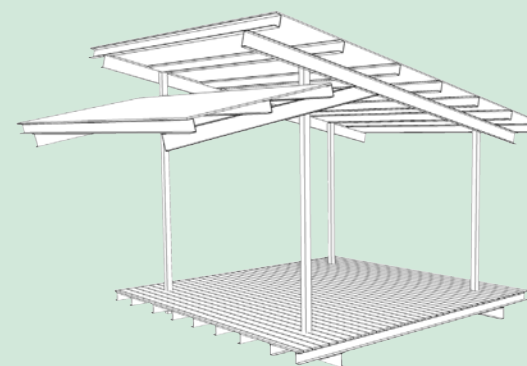

\$7,000

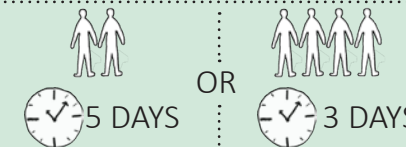

BASIC LIVING SHELTER + THE WORKS

DIMENSIONS

Width 4.0 metres
Height 2.7 metres
Length 5.0 metres.

DESCRIPTION

Steel framed outdoor living shelter with Zinalume roof and raised platform with Modwood decking. Simple structure which can be used for many different purposes.
Platform 0.5 high.

CONTENTS

4 x Steel posts
20 x Steel purlins
7 x sheets Zinalume Roofing
23 x Modwood Decking boards
130 x Bolts and washers
650 x Tek screws
Concrete mix as required

TOOLS AND EQUIPMENT



CONSTRUCTION OVERVIEW



Digging holes



Bolting steel together

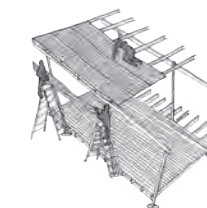

Screwing on roofing



Install Platform

.....a shelter for cooking

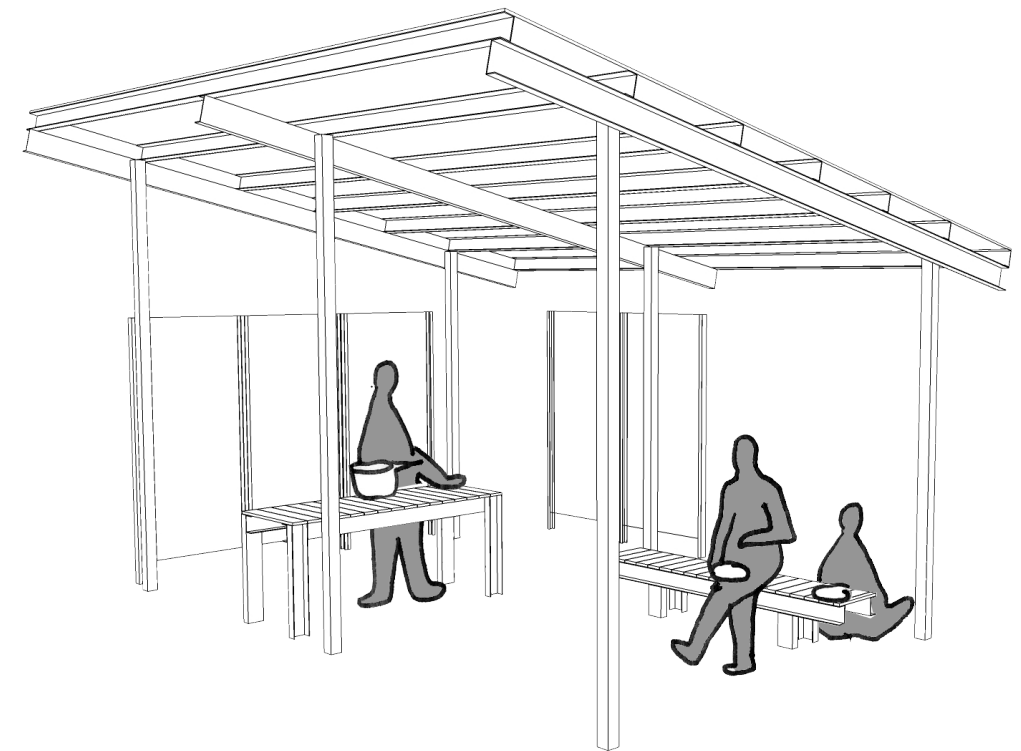

Kitchen Shelter \$6,000

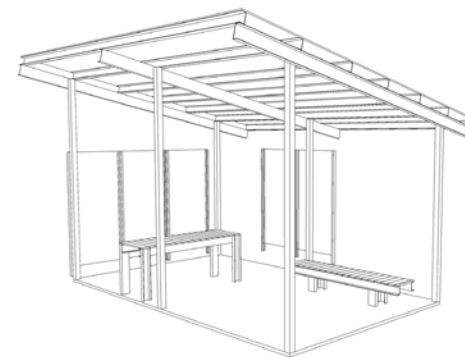

Kitchen Shelter + Slab \$8,000

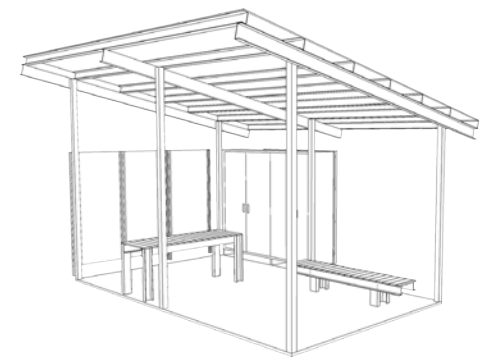

Kitchen Shelter + Slab + Storage \$9,000

Add-Ons

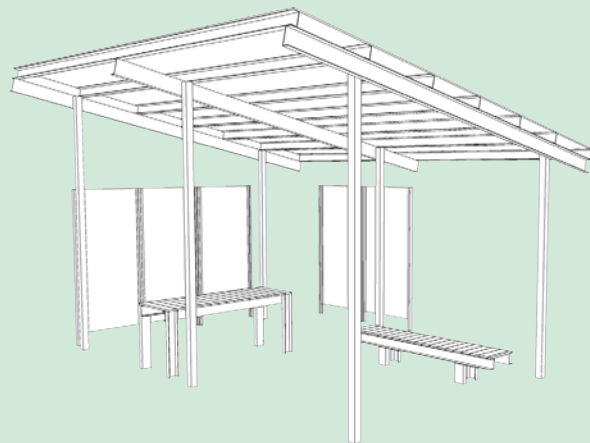

\$6,000

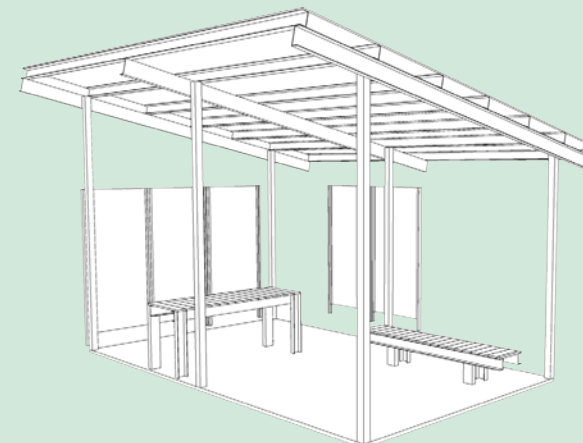
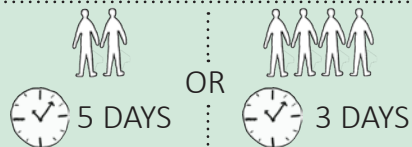

\$8,000

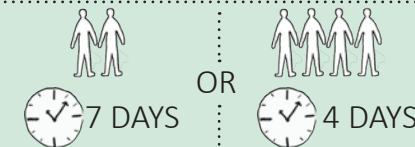

KITCHEN SHELTER

DIMENSIONS

Width 6.4 metres
Height 2.7 metres
Length 5.7 metres.

DESCRIPTION

Steel framed kitchen shelter with stainless steel sink on preparation bench and Modwood bench/low table.

CONTENTS

6 x Steel posts
12 x Steel purlins
10 x sheets Zincalume Roofing
80 x Bolts and washers
270 x Tek screws
Concrete mix as required
5 x Screens
10 x Modwood Decking
1 x Sink Kit

TOOLS AND EQUIPMENT



CONSTRUCTION OVERVIEW



Digging holes



Bolting steel together

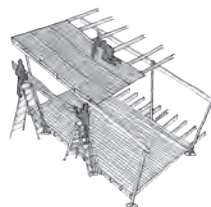

Screwing on roofing



Install Kitchen

KITCHEN SHELTER + SLAB

DIMENSIONS

Width 6.4 metres
Height 2.7 metres
Length 5.7 metres.

DESCRIPTION

Steel framed kitchen shelter with stainless steel sink on preparation bench, Modwood bench/low table on concrete slab.

CONTENTS

6 x Steel posts
12 x Steel purlins
10 x sheets Zincalume Roofing
80 x Bolts and washers
270 x Tek screws
Concrete mix as required
5 x Screens
10 x Modwood Decking
1 x Sink Kit

TOOLS AND EQUIPMENT



CONSTRUCTION OVERVIEW



Dig holes, pour slab



Bolting steel together



Screwing on roofing



Install Kitchen



“Outdoor cooking is easier
with a sink nearby”

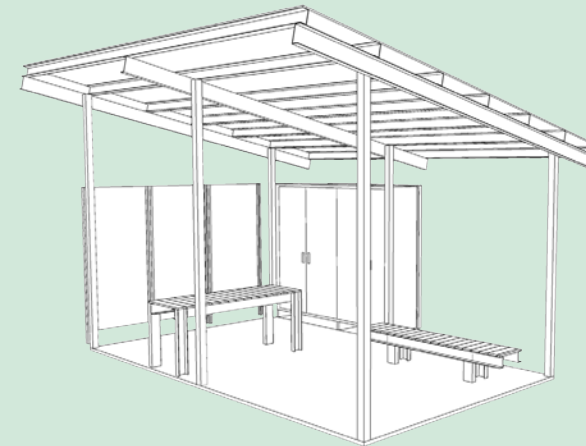

\$9,000

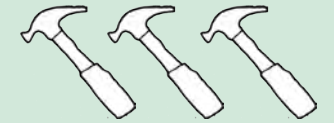
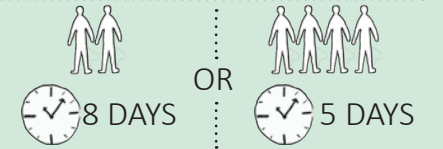

KITCHEN SHELTER + SLAB + STORAGE

DIMENSIONS

Width 6.4 metres
Height 2.7 metres
Length 5.7 metres.

DESCRIPTION

Steel framed kitchen shelter with stainless steel sink on preparation bench, Modwood bench/low table on concrete slab and fixed, lockable storage units.

CONTENTS

6 x Steel posts
12 x Steel purlins
10 x sheets Zincalume Roofing
80 x Bolts and washers
270 x Tek screws
Concrete mix as required
3 x Screens
10 x Modwood Decking
1 x Sink Kit
2 x Lockable Storage Units

TOOLS AND EQUIPMENT



CONSTRUCTION OVERVIEW



Dig holes, pour slab

Bolting steel
together

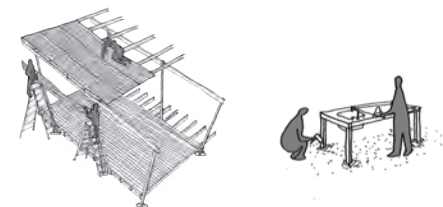

Screwing on roofing

Install Kitchen



“Screens create shade and can enclose a shelter”

.....for shade or privacy

STEP 1 Choose the number of screens

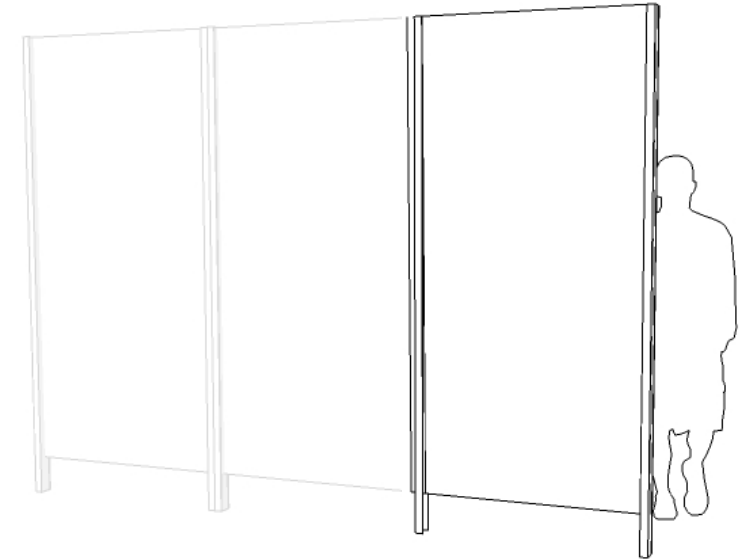

STEP 2 Choose your screening material



Steel Mesh



Modwood

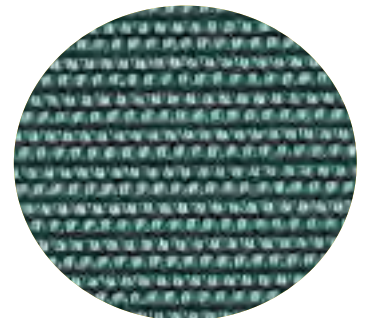

Shade cloth

Add-Ons

“The screens are great as they let light in while giving us some privacy...”

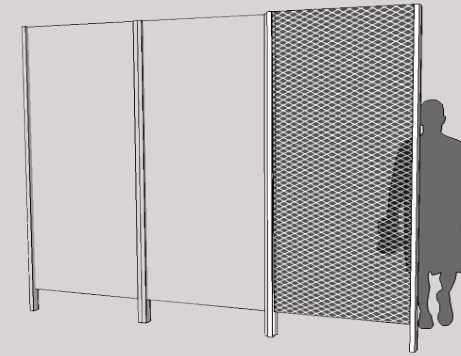

\$1,000

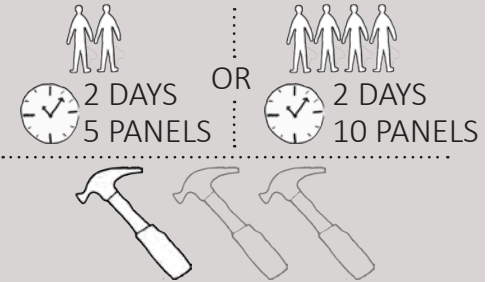

PRIVACY SCREEN - METAL MESH

DIMENSIONS

Width 1.2 metres
Height 2.6 metres

DESCRIPTION

A single panel module, steel mesh screens can be used in conjunction with shelters, play equipment and storage to provide privacy and shelter from wind and dust.

CONTENTS

2 x Steel posts
1 x Steel mesh screen
12 x Tek screws
Concrete mix as required

TOOLS AND EQUIPMENT

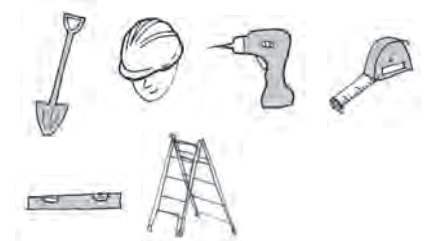

CONSTRUCTION OVERVIEW



Digging holes



Bolting steel together



Fixing Screen to Frame

Add-Ons



\$1,000

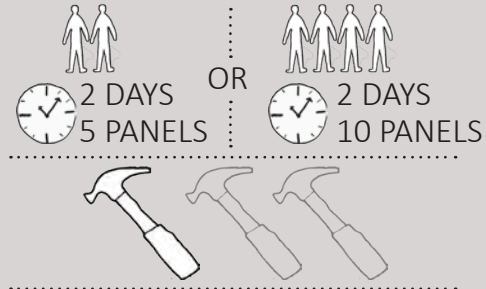

PRIVACY SCREEN - MODWOOD

DIMENSIONS

Width 1.2 metres
Height 2.6 metres

DESCRIPTION

A single panel module, modwood screens can be used in conjunction with shelters, play equipment and storage to provide privacy and shelter from wind and dust.

CONTENTS

2 x Steel posts
8 x Modwood Decking Boards
80 x Tek screws
Concrete mix as required

TOOLS AND EQUIPMENT



CONSTRUCTION OVERVIEW



Digging holes



Bolting steel together



Fixing Modwood to Frame

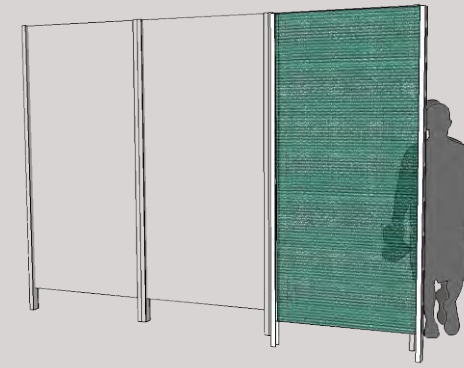

\$600

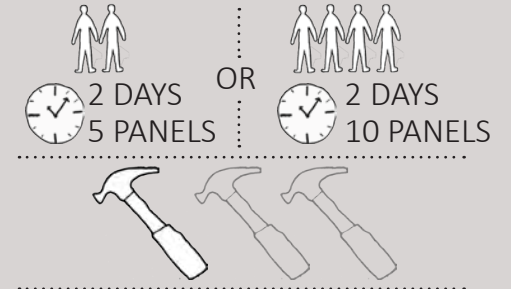

PRIVACY SCREEN - SHADE CLOTH

DIMENSIONS

Width 1.2 metres
Height 2.6 metres

DESCRIPTION

A single panel module, shade cloth screens can be used in conjunction with shelters, play equipment and storage to provide privacy and shelter from wind and dust.

CONTENTS

2 x Steel posts
1 x steel frame
1 x shade cloth
15 x Tek screws
Concrete mix as required

TOOLS AND EQUIPMENT



CONSTRUCTION OVERVIEW



Digging holes



Bolting steel together



Fix shade cloth to posts

.....for enclosing an area

STEP 1 Choose the length of fence

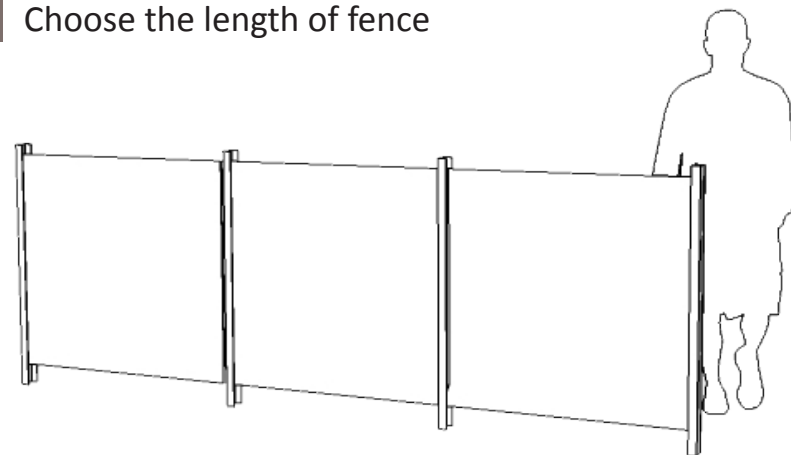

STEP 2 Choose your fencing material



Metal Mesh



Modwood

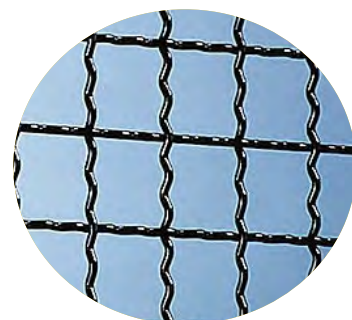

Wire Lattice

STEP 3 Choose your accessories

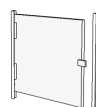

Single Gate

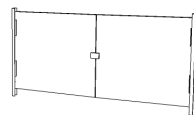

Double Gate



Basketball Ring



Footy Posts

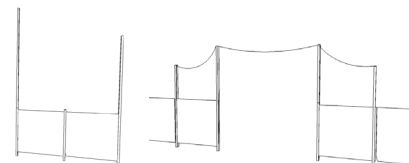

Washing Line

\$500/m

2 DAYS 6 METRES OR 2 DAYS 12 METRES

FENCING - METAL MESH

DIMENSIONS
Width 1.2 metres
Height 1.3 metres

DESCRIPTION
Fence panels can be combined to enclose your yard. They can also be installed with gates, ball sports posts or a washing line.

CONTENTS
2 x Steel posts
1 x Metal mesh panel
12 x Tek screws
Concrete mix as required

TOOLS AND EQUIPMENT



CONSTRUCTION OVERVIEW



Digging holes



Installing Posts



Fixing Screen to Frame

Add-Ons

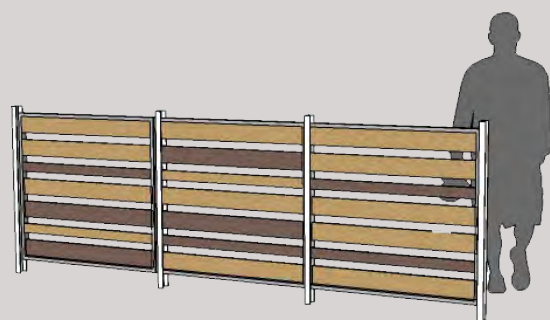

\$500/m

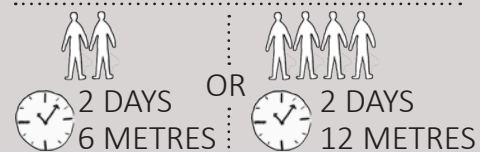

FENCING - MODWOOD

DIMENSIONS

Width 1.2 metres

Height 1.3 metres

DESCRIPTION

Fence panels can be combined to enclose your yard. They can also be installed with gates, ball sports posts or a washing line to add further amenity to your home.

CONTENTS

2 x Steel posts

5 x Modwood Deck Boards

130 x Tek screws

Concrete mix as required

TOOLS AND EQUIPMENT



CONSTRUCTION OVERVIEW



Digging holes



Installing Posts



Screwing on Modwood

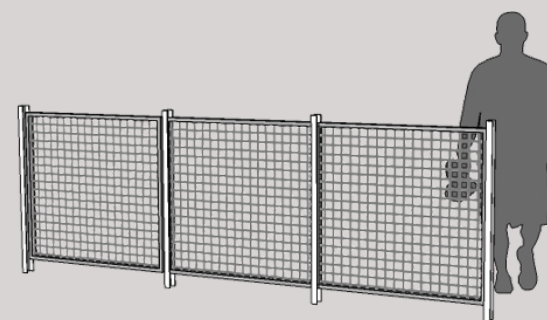

\$350/m

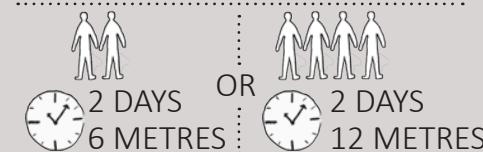

FENCING - WIRE LATTICE

DIMENSIONS

Width 1.2 metres

Height 1.3 metres

DESCRIPTION

Fence panels can be combined to enclose your yard. They can also be installed with gates, ball sports posts or a washing line to add further amenity to your home.

CONTENTS

2 x Steel posts

1 x Wire lattice panel

12 x Tek screws

Concrete mix as required

TOOLS AND EQUIPMENT



CONSTRUCTION OVERVIEW



Digging holes



Bolting steel together



Screwing on lattice

Add-Ons

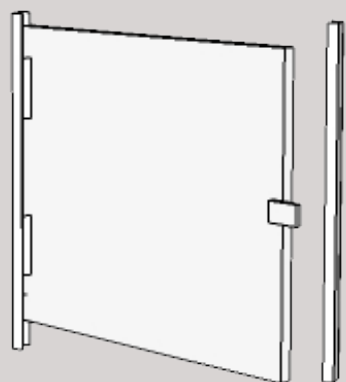

**\$ COST DEPENDENT
ON MATERIAL CHOICE**

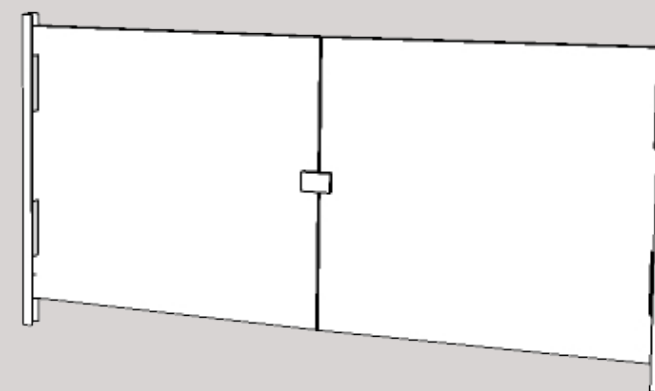

**\$ COST DEPENDENT
ON MATERIAL CHOICE**



GATE - SINGLE



Metal Mesh
\$900



Modwood
\$900

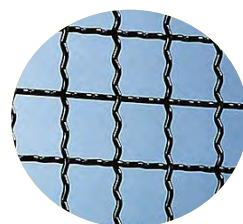

Wire Lattice
\$600

DIMENSIONS
Width 1.2 metres
Height 1.3 metres

DESCRIPTION
Single gate in selected material
to suit chosen fence.

CONTENTS
2 x Steel posts
1 x Selected material panel
12 x Tek screws
Concrete mix as required

TOOLS AND EQUIPMENT



CONSTRUCTION OVERVIEW



Digging holes



Installing Posts



Fixing Panels

GATE - DOUBLE



Metal Mesh
\$2000



Modwood
\$2000

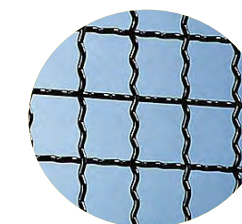

Wire Lattice
\$1400

DIMENSIONS
Width 3.0 metres
Height 1.3 metres

DESCRIPTION
Double gate in selected material
to suit chosen fence.

CONTENTS
2 x Steel posts
2 x Selected material panels
34 x Tek screws
Concrete mix as required

TOOLS AND EQUIPMENT



CONSTRUCTION OVERVIEW



Digging holes



Installing Posts



Fixing Panels

Add-Ons

“Turning a yard into a footy ground is easy!”

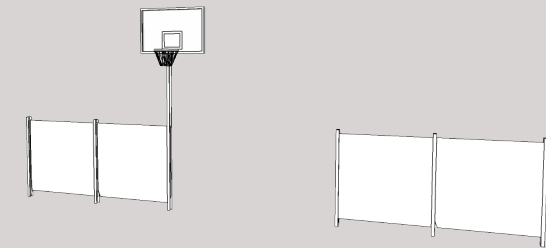

BASKETBALL RING

DESCRIPTION
Basketball Ring and back board, mounted on a steel post.
*fence sold separately

\$2000

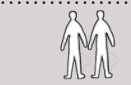

1 DAY

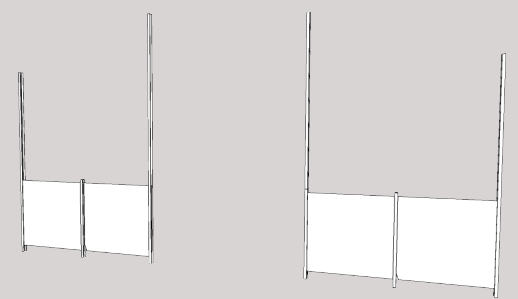

FOOTY POSTS

DESCRIPTION
Goal Posts for ball sports
*fence sold separately

\$2000



1 DAY

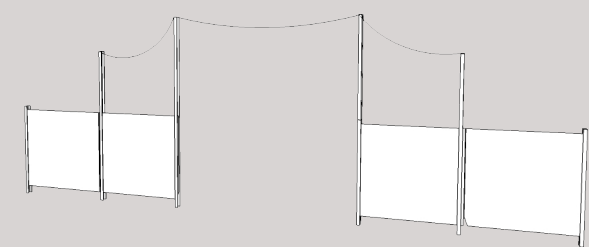

WASHING LINE

DESCRIPTION
Plastic Coated Wire Washing Line strung between posts
*fence sold separately

\$1500

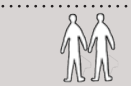

1 DAY

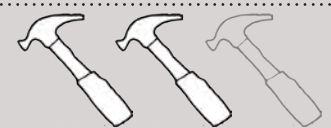

Add-Ons



[Contact Us](#)

Contact Us!

If you have any further questions or need more information, please contact the Homes Plus team on the contacts below!

Web

www.bowerhomesplus.com.au

Email

contact@bowerhomesplus.com.au

Mail

Homes Plus
Room 411, Architecture Building
757 Swanston Street
University of Melbourne VIC 3010
AUSTRALIA

Phone

T +61 3 8344 8761



Making Partnerships ...

The Bower Homes Plus team have worked extensively with Indigenous Communities and their representative bodies as well as many industry partners in delivering past projects. The productive relationships developed over the course of these projects is built on respect and appreciation.

For more information on becoming part of the Bower Homes Plus Team, please contact David O’Brien at the University of Melbourne on +61 3 8344 8761 or djobrien@unimelb.edu.au





Order Form

Email Address: _____ Phone Number: _____

5

5

5

Home C

[illegible]

Once complete, tear this order form out, fold and seal it then send it to the Home Plus Team.

TEAR HERE.....

III

Homes Plus
Reply Paid 3345
Perth, 6000 WA

Order Form

Email Address: _____ Phone Number: _____

☐ Home A ☐ Home B ☐ Home C

Once complete, tear this order form out, fold and seal it then send it to the Home Plus Team.

.....
TEAR HERE

FOLD

No stamp required
if posted in Australia

Homes Plus
Reply Paid 3345
Perth, 6000 WA

FOLD



“We can help paint...”

Published by

Melbourne School of Design
Faculty of Architecture, Building and
Planning
The University of Melbourne
Victoria, Australia
www.apb.unimelb.edu.au

Compiled by

David O’Brien, Stephanie Richardson,
Fiona Lew and George Stavrias



msd

Melbourne
School of Design

© 2013 The University of Melbourne
All Rights Reserved



www.bowerhomesplus.com.au